

MEETING ROOMS

VITTORIA BALLROOM

La sala Vittoria si distingue per le sue dimensioni e gli splendidi affreschi che impreziosiscono il soffitto a volta di 4,70 m di altezza. Si tratta di una sala unica nel suo genere utilizzata principalmente per cene di gala esclusive ed eventi prestigiosi.

Posizionata al piano terra, di fronte al Golfo di Napoli ed al Vesuvio, questo notevole spazio di 240 mq può ospitare fino a 200 persone. Particolarmente indicata per conferenze, riunioni aziendali, presentazioni di nuovi prodotti, pranzi e cene. Insieme alla splendida terrazza adiacente, la sala Vittoria è il luogo ideale per eventi indimenticabili.

The fabulously frescoed Vittoria Ballroom is distinguished by its dimensions and exquisite embellishments. This is a unique meeting room mainly used for Gala dinners and prestigious events.

An incredible location on the ground floor facing the Bay of Naples and Vesuvius, this remarkable 240 sqm space with 4.70 m vaulted ceilings with frescos can seat up to 200 people. It is perfect for conferences, company meetings, new product presentations, lunch and dinner meetings. Together with the amazing adjoining terrace, the Vittoria Ballroom is destined to create unforgettable memories for your delegates and guests.

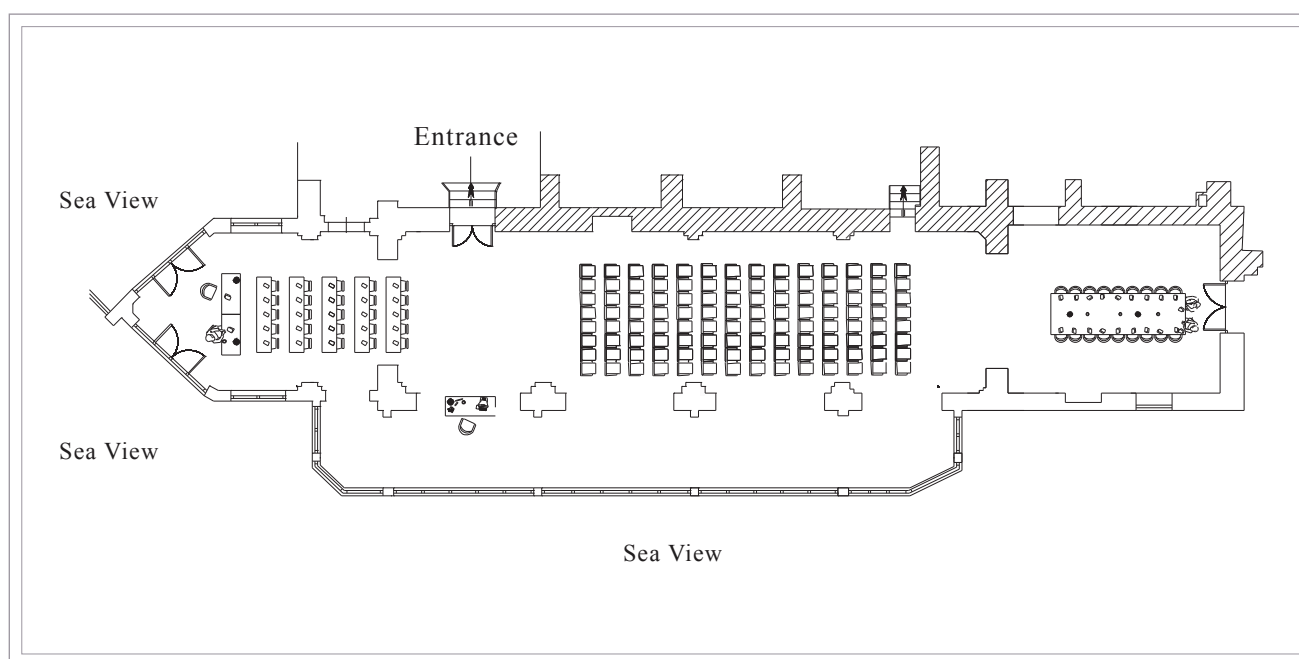

	Mq. Sqmt.	Lung. Lgth.	Larg. Wdth.	Alt. Hght.	Piano Floor					
Vittoria Ballroom	240	40	6	4,70	0	240	120	280	120	350

MEETING ROOMS

TARANTELLA MEETING ROOM

La Sala Tarantella di 80 mq con un soffitto alto 4.70 m puo' ospitare fino ad un massimo di 70 persone. Situata in un'area riservata dell'hotel, quest'ampia sala garantisce la massima privacy ed è ideale per riunioni di medie dimensioni.

A spacious and bright space with maximum privacy, the Tarantella meeting room is 80 sqm with a 4.70 m high ceiling and can seat up to 70 people.

Located one floor down from the ground floor, this provides a special space which is ideal for mid-sized meetings.

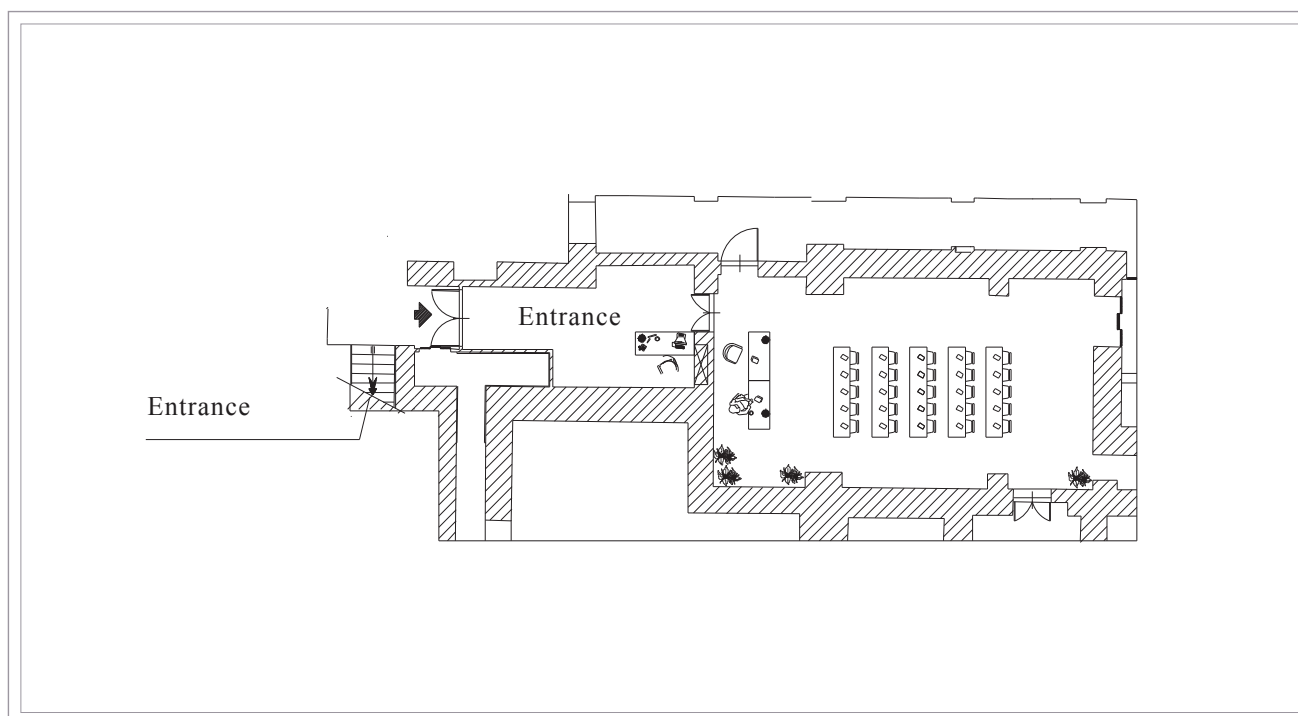

	Mq. Sqmt.	Lung. Lgth.	Larg. Wdth.	Alt. Hght.	Piano Floor					
Tarantella Meeting Room	80	12,70	6,40	4,30	-1	70	40	80	30	50

MEETING ROOMS

DEL MORO & STUART





Le Sale Del Moro e Stuart sono due sale riunioni adiacenti che godono di luce naturale ed offrono una vista mozzafiato sul Golfo di Napoli e sul Vesuvio.

Questi due spazi di circa 40 mq ciascuno con soffitti alti 4,30 m possono ospitare fino a 35 persone per sala. Privati e funzionali, sono perfetti per riunioni aziendali di piccole dimensioni, comunicati stampa, presentazioni di nuovi prodotti.

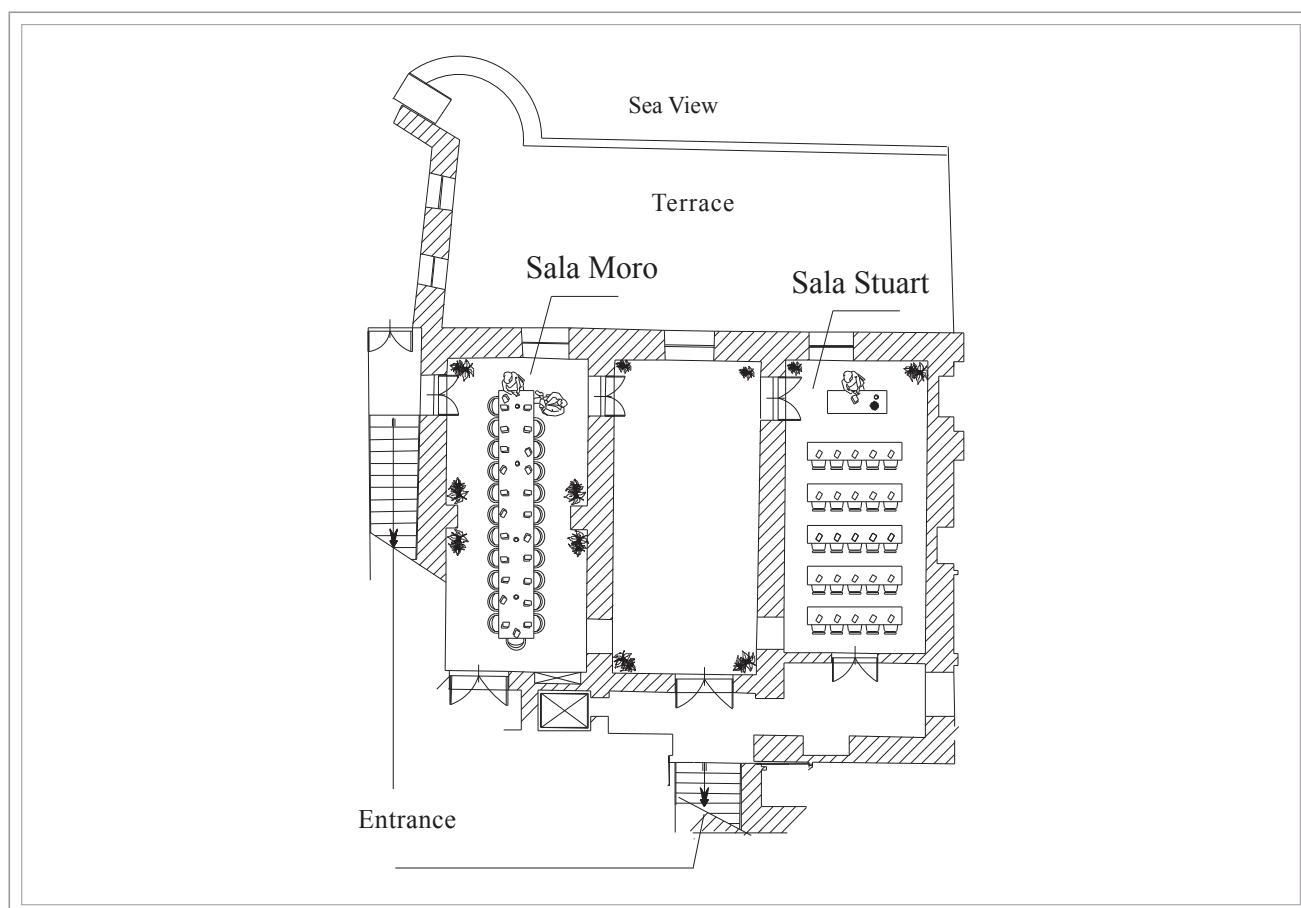
Del Moro and Stuart are two smaller, adjacent meeting rooms with a stunning view of the Bay of Naples and Vesuvius.

These two small 40 sqm spaces with 4.30 m high ceilings can seat up to 35 people. Private and functional, they are perfect for smaller company meetings, press releases, new product presentations.



	Mq. Sqmt.	Lung. Lgth.	Larg. Wdth.	Alt. Hght.	Piano Floor					
Stuart Meeting Room	41	9,40	4,40	4,20	-1	35	20	24	20	20
Moro Meeting Room	40	9,40	4,30	4,20	-1	35	20	20	12	15

MEETING ROOMS

BOARDROOM & STUDIO

La proposta dell'Excelsior Vittoria per rispondere alle esigenze di piccoli gruppi di lavoro, queste due accoglienti sale meeting, situate al piano terra, sono ideali per riunioni di lavoro e briefing.

The Boardroom: Elegante e raffinata, può ospitare fino a 12 persone. È dotata di connessione Wi-Fi, smart Tv e dispositivi di videoconferenza. Il nostro personale tecnico è a disposizione per ogni necessità.





The Studio: Quest'ambiente intimo e moderno può ospitare fino a 6 persone. La connessione Wi-Fi, uno smart Tv e l'assistenza del nostro personale tecnico garantiscono condizioni di lavoro ideali.

The hotel has two meeting rooms adjacent to each other on the ground floor which are ideal for business or board meetings.

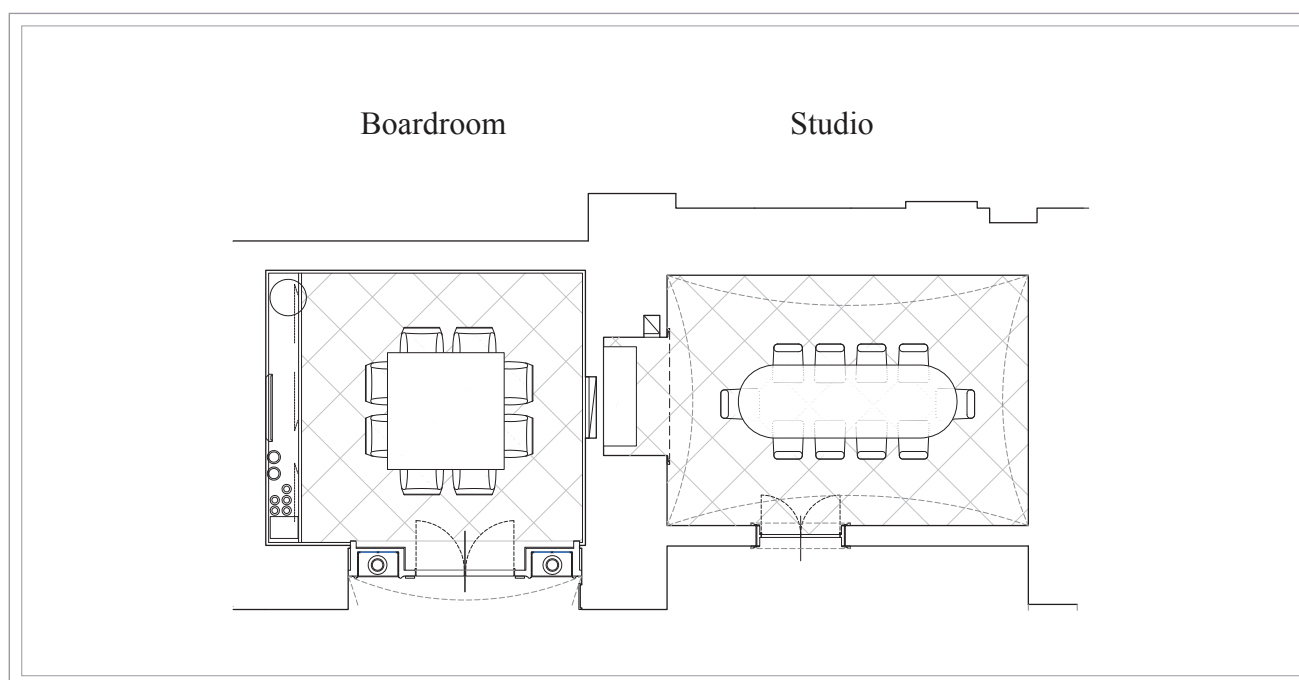
***The Boardroom:** Seating 12 in calm sophistication, the boardroom is equipped with video conferencing devices and a smart TV. A Wi-Fi connection is available, and our technical team is on standby to assist should you need them.*

***The Studio:** This modern studio comfortably hosts six people needing a more intimate space in which to work. The studio is equipped with a smart TV and Wi-Fi connection, with our technical team available to assist if necessary.*



	Mq. Sqmt.	Lung. Lgth.	Larg. Wdth.	Alt. Hght.	Piano Floor					
Boardroom	16	4,30	3,60	2,85	0	-	-	12	-	-
Studio	17	4,95	3,43	3,20	0	-	-	6	-	-